

G101  
pianerottolo 1 (gradino 10 su rampa 1)  
acciaio piegato a freddo e forato + gomma  
s: 10mm L=1240mm

G12  
pianerottolo 2 (gradino 1 su rampa 2)  
acciaio piegato a freddo e forato + gomma  
s: 10mm L=1240mm

G3  
pianerottolo 3  
(collegamento fra P1 e P2)  
acciaio piegato a freddo e forato + gomma  
s: 10mm L=80mm

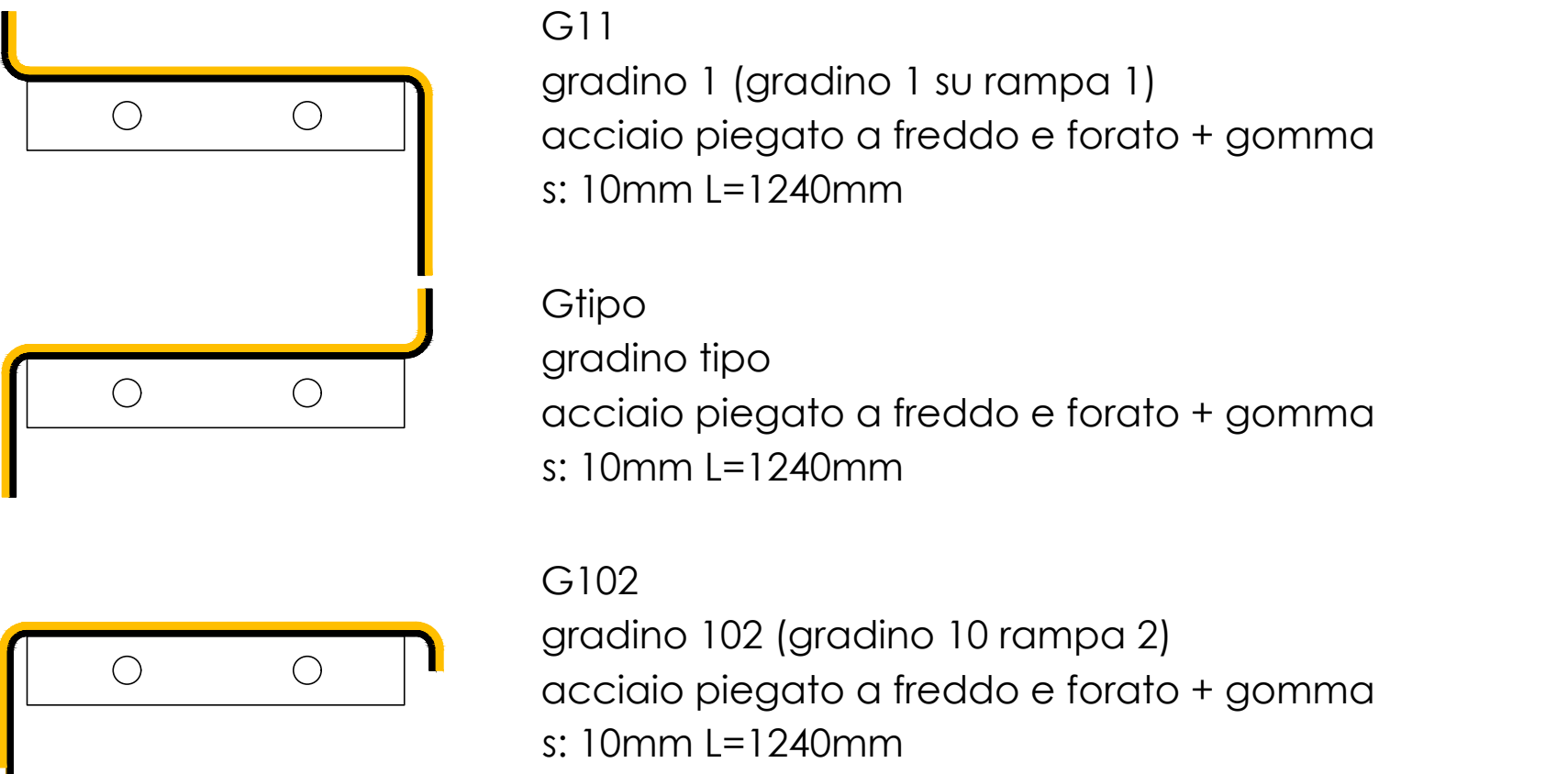

G11  
gradino 1 (gradino 1 su rampa 1)  
acciaio piegato a freddo e forato + gomma  
s: 10mm L=1240mm

Gtipo  
gradino tipo  
acciaio piegato a freddo e forato + gomma  
s: 10mm L=1240mm

G102  
gradino 102 (gradino 10 rampa 2)  
acciaio piegato a freddo e forato + gomma  
s: 10mm L=1240mm

UNIVERSITA' DEGLI STUDI DI CATANIA  
DICAR  
CdL Ingegneria Edile - Architettura

Corso di Tecnica delle Costruzioni +  
LAB Tecnica delle Costruzioni  
A.A. 2016 / 2017

DOCENTI:  
Prof. **Edoardo Marino**, Prof.ssa **Melina Bosco**

OGGETTO: **scala in officina**

- abaco dei gradini (sezione) 1.5
- travi UPN P21 P22 P23 P24 1.10
- pilastri HEB P11 P12 P13 P14 1.10
- profili L (collegamento trasversale) P31 P32 P33 P34 1.10
- travi UPN P41 P42 (testata) 1.10

ALLIEVI  
**Federico Noto**  
O58/000108  
**Massimiliano Pappalardo**  
O58/000140

REVISORI  
**Aurelio Gheri**  
  
**William Leni**

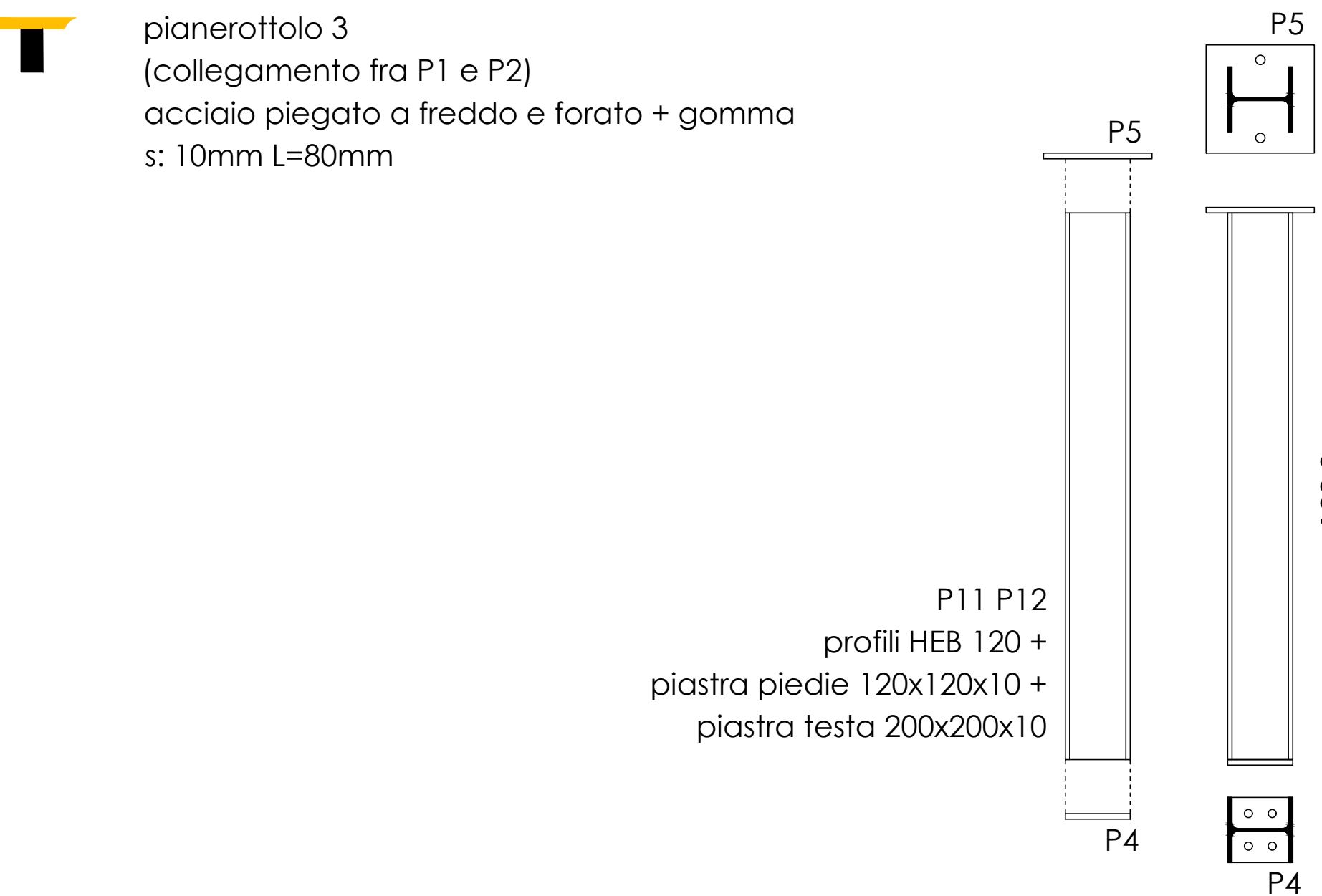

P11 P12  
profili HEB 120 +  
piastra piedie 120x120x10 +  
piastra testa 200x200x10

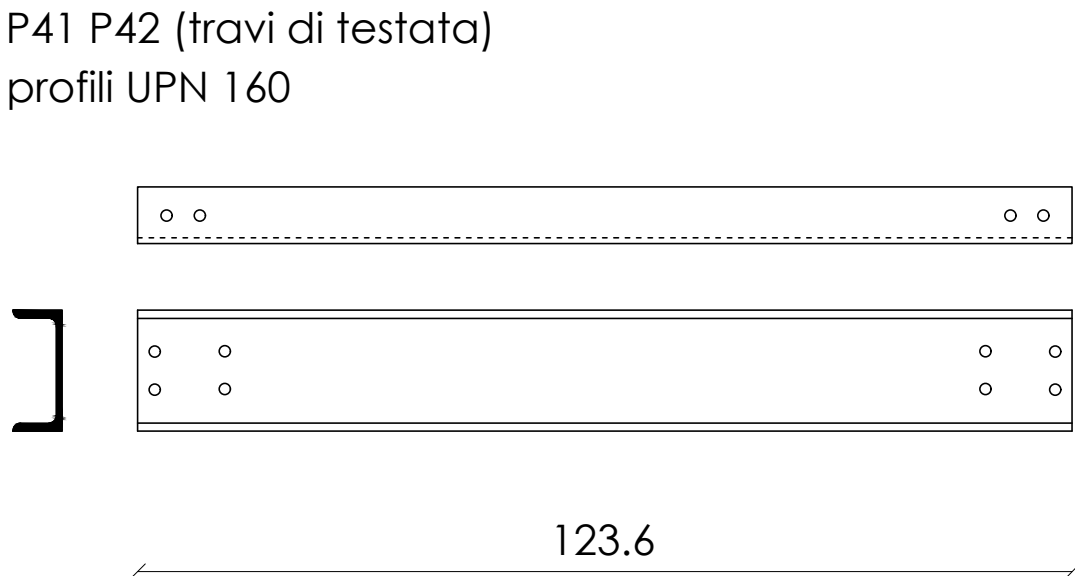

P41 P42 (travi di testata)  
profili UPN 160

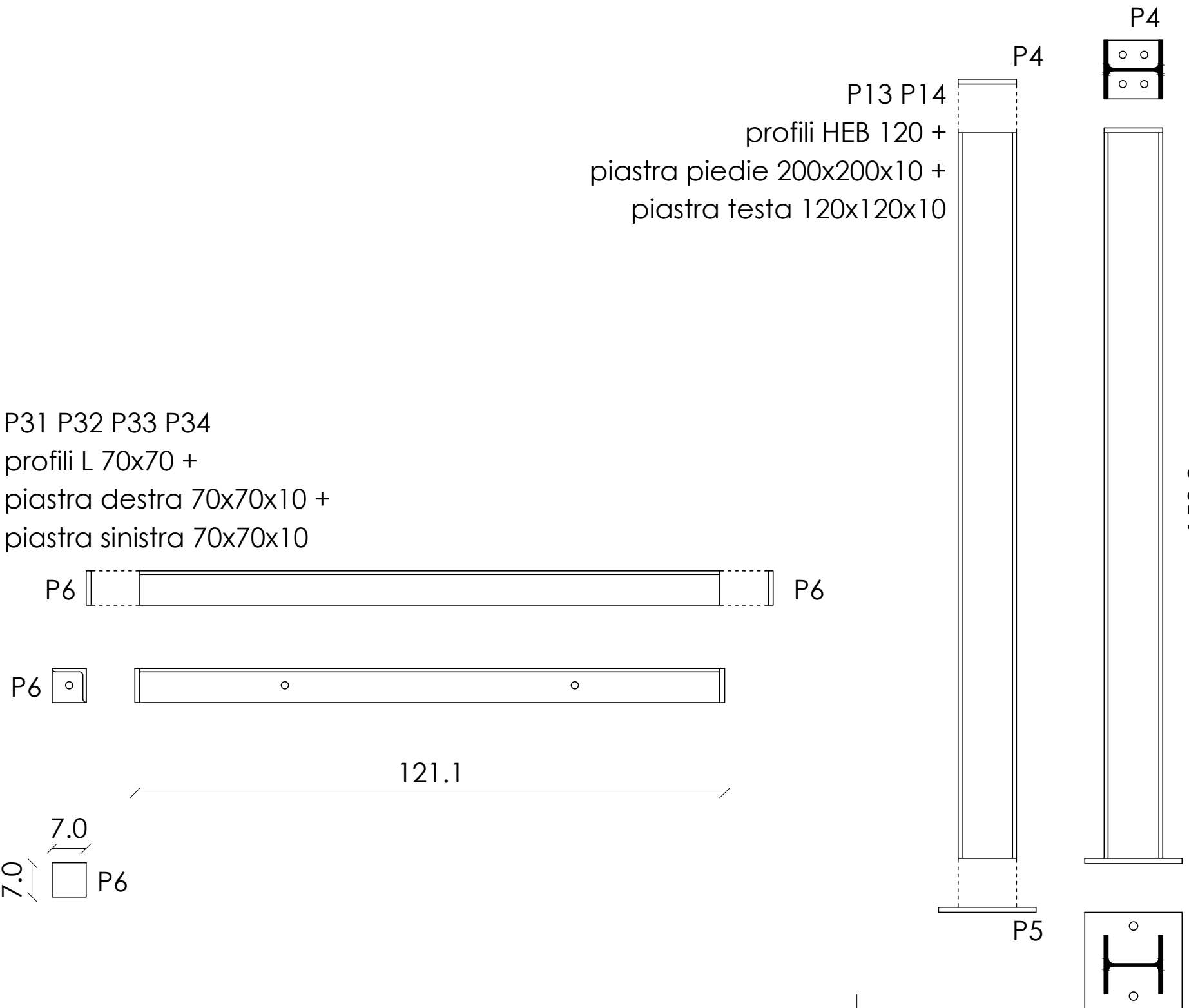

P13 P14  
profili HEB 120 +  
piastra piedie 200x200x10 +  
piastra testa 120x120x10

P31 P32 P33 P34  
profili L 70x70 +  
piastra destra 70x70x10 +  
piastra sinistra 70x70x10

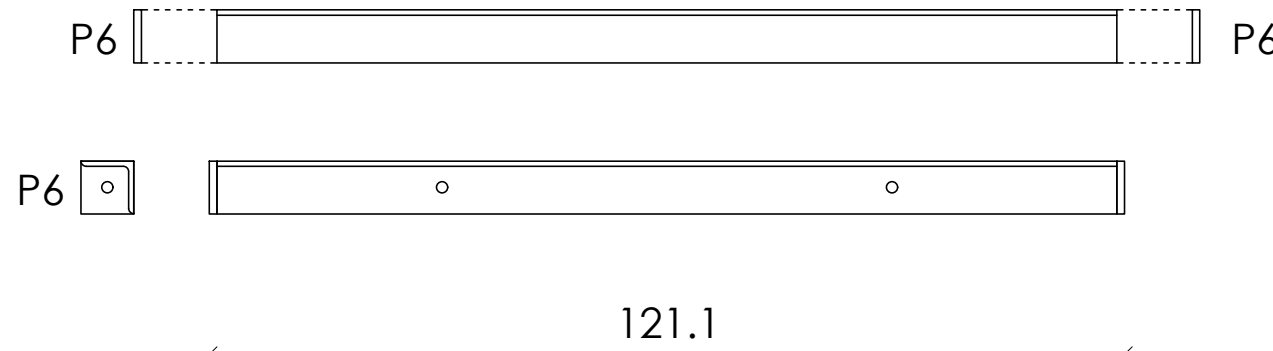

P6

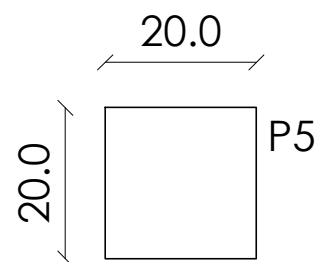

P21 P22 (specchiata)  
profilo UPN 160 +  
profilo L (sinistra) 60x80x8, h100 +  
piastra (destra) 150x280x10 +  
piastre (supporti pedate) +  
piastre (rinforzi supporto pedate)  
UPN160

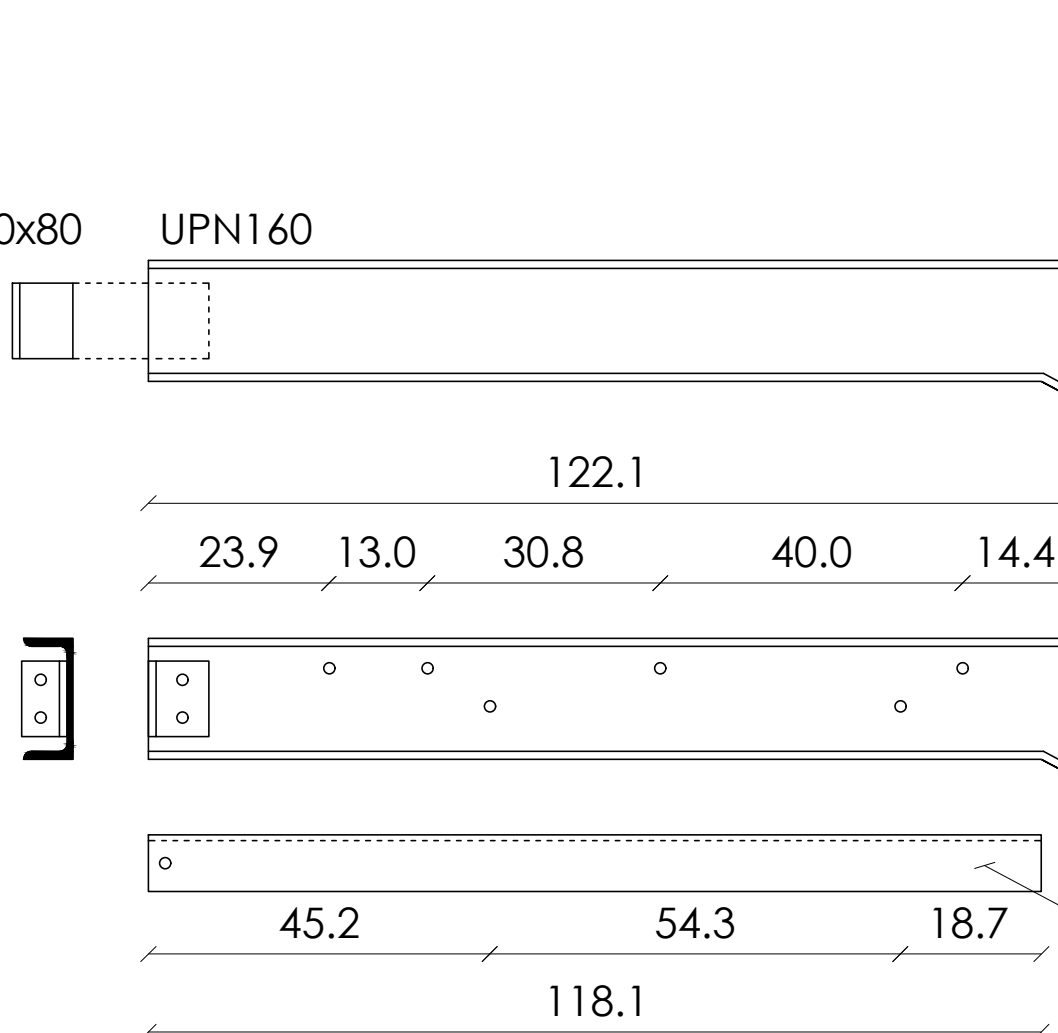
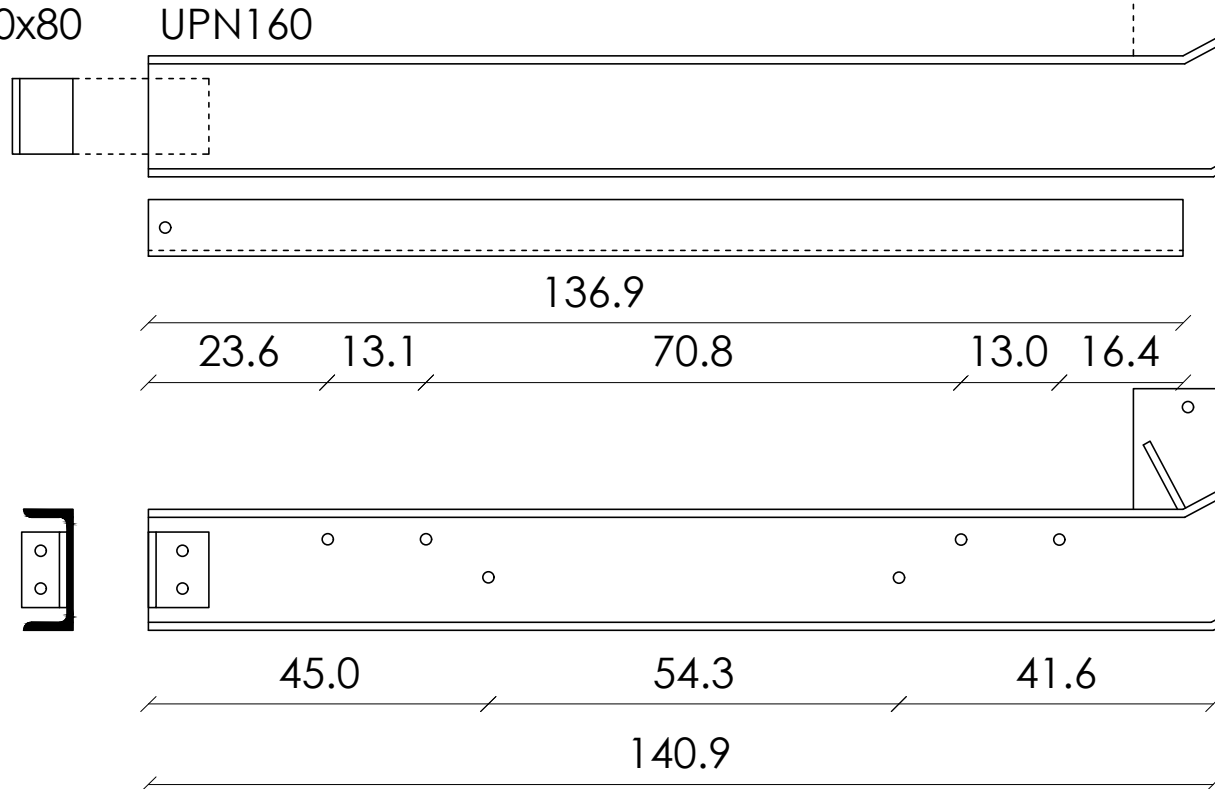

P23 P24 (specchiata)  
profilo UPN 160 +  
profilo L (sinistra) 60x80x8, h100 +  
piastra (destra) 150x280x10 +  
piastre (supporti pedate) +  
piastre (rinforzi supporto pedate)

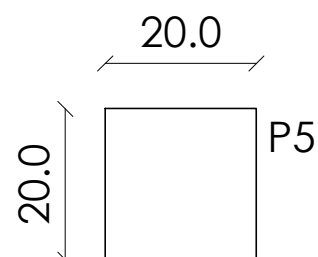

P5

